

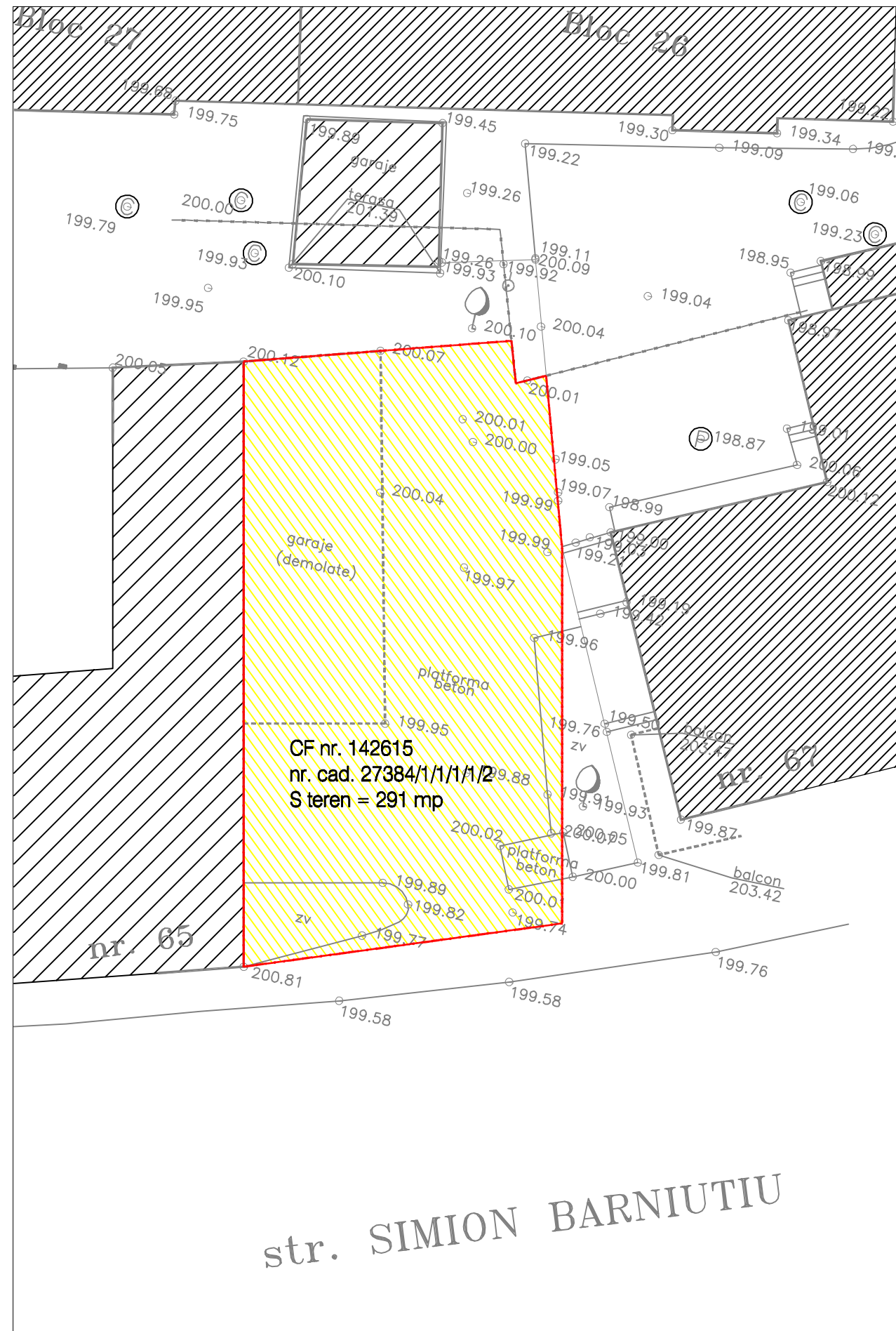



P.U.D. - SPATII COMERCIALE SI LOCUINTE

Str. Simion Barnutiu nr. 65 - 67

SITUATIA EXISTENTA

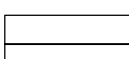

LEGENDA

-  LIMITA DE PROPRIETATE = LIMITA ZONEI STUDIATE
-  TEREN PROPRIETATE PRIVATA
-  CLADIRI EXISTENTE
-  DRUMURI PUBLICE EXISTENTE
- 200.00 COTE NIVEL TEREN NATURAL

Timisoara, strada Memorandului nr.93, tel/fax 0256/294218, J35/234/99, e-mail office@studioarca.ro

studio **arca** srl

beneficiar: s.c. PRO MAREK s.r.l.
den. lucrare: SPATII COMERCIALE SI LOCUINTE
adresa: Timisoara, str. Simion Barnutiu nr. 65 - 67

pr. nr.
179/2006

SEF PROIECT	arh. Radu GOLUMBA	scara
PROIECTAT	arh. Radu GOLUMBA	1:200
DESENAT	arh. Calin PASCU	
VERIFICAT	arh. Claudiu OPRITA	iun.2006

plansa:
SITUATIA EXISTENTA

feza
P.U.D.
pl. nr.
02A