

TAMPLARIE-FERESTRE PROPUSE SPRE SCHIMBARE-						
NR. ID.	SPATIUL AFERENT	DETALII	NR. BUC.	L x H	SUPRAFATA	VEDERE EXT.
FA1 hol lemn	---	tamplarie lemn	5	1.60x0.83	1.33	
FA2 hol lemn	---	tamplarie lemn	4	1.60x0.65	1.04	
FA2 hol lemn	Casa scarii	tamplarie lemn	1	1.60x0.65	1.04	
FAAP12 metal	Loja	tamplarie metal	1	2.70x1.60	4.32	
FAAP14 metal	Loja	tamplarie metal	1	2.70x1.60	4.32	
FAAP17 lemn	Baie	tamplarie lemn	1	0.60x0.60	0.36	
FAAP17 lemn	Bucatarie	tamplarie lemn	1	1.15x1.30	1.50	
FAAP17 lemn	Camera 1	tamplarie lemn	1	2.35x1.30	3.06	
FAAP17 metal	Loja	tamplarie metal	1	2.70x1.60	4.32	
FAAP20 lemn	Baie	tamplarie lemn	1	0.60x0.60	0.36	
FAAP20 lemn	Bucatarie	tamplarie lemn	1	1.15x1.30	1.50	
FAAP20 lemn	Camera 1	tamplarie lemn	1	2.35x1.30	3.06	
FA spalatorie lemn	Spalatorie	tamplarie lemn	1	1.15x1.30	1.50	
FB1 hol lemn	---	tamplarie lemn	5	1.60x0.83	1.33	
FB2 hol lemn	---	tamplarie lemn	4	1.60x0.65	1.04	
FB2 hol lemn	Casa scarii	tamplarie lemn	1	1.60x0.65	1.04	
FB AP10 lemn	Bucatarie	tamplarie lemn	1	1.15x1.30	1.50	
FB AP10 lemn	Camera 3	tamplarie lemn	1	1.15x1.30	1.50	
FB AP20 lemn	Baie	tamplarie lemn	1	0.60x0.60	0.36	
FB AP20 lemn	Bucatarie	tamplarie lemn	1	1.15x1.30	1.50	
FB AP20 lemn	Camera 1	tamplarie lemn	1	2.35x1.30	3.06	
FB spalatorie lemn	Spalatorie	tamplarie lemn	1	1.15x1.30	1.50	

**NOTA**  
 Tamplaria de PVC si detaliile aferente acesteia se vor alege de catre beneficiar impreuna cu un reprezentant al producatorului. Modalitatea de deschidere a usilor si mobile se vor alege, de asemenea, de catre beneficiar, impreuna cu reprezentantul producatorului. Directia de deschidere din plan este stabilita doar orientativ de catre arhitect.

TAMPLARIE-FERESTRE PROPUSE SPRE SCHIMBARE-						
NR. ID.	SPATIUL AFERENT	DETALII	NR. BUC.	L x H	SUPRAFATA	VEDERE EXT.
FC1 hol lemn	---	tamplarie lemn	5	1.60x0.83	1.33	
FC2 hol lemn	---	tamplarie lemn	4	1.60x0.65	1.04	
FC2 hol lemn	Casa scarii	tamplarie lemn	1	1.60x0.65	1.04	
FC AP1 lemn	Camera 1	tamplarie lemn	1	2.35x1.30	3.06	
FC AP1 metal	Loja	tamplarie metal	1	2.70x1.60	4.32	
FC AP5 lemn	Baie	tamplarie lemn	1	0.60x0.60	0.36	
FC AP5 lemn	Bucatarie	tamplarie lemn	1	1.15x1.30	1.50	
FC AP5 lemn	Camera 1	tamplarie lemn	1	2.35x1.30	3.06	
FC AP5 metal	Loja	tamplarie metal	1	2.70x1.60	4.32	
FC AP7 lemn	Baie	tamplarie lemn	1	0.60x0.60	0.36	
FC AP7 lemn	Bucatarie	tamplarie lemn	1	1.15x1.30	1.50	
FC AP7 lemn	Camera 1	tamplarie lemn	1	2.35x1.30	3.06	
FC AP13 lemn	Baie	tamplarie lemn	1	0.60x0.60	0.36	
FC AP13 lemn	Bucatarie	tamplarie lemn	1	1.15x1.30	1.50	
FC AP13 lemn	Camera 1	tamplarie lemn	1	2.35x1.30	3.06	
FC AP13 metal	Loja	tamplarie metal	1	2.70x1.60	4.32	
FC AP19 lemn	Baie	tamplarie lemn	1	0.60x0.60	0.36	
FC AP19 lemn	Bucatarie	tamplarie lemn	1	1.15x1.30	1.50	
FC AP19 lemn	Camera 1	tamplarie lemn	1	2.35x1.30	3.06	
FC spalatorie lemn	Spalatorie	tamplarie lemn	1	1.15x1.30	1.50	



VERIFICATOR/ EXPERT	NUME	SEMNTATURA	CERINTA	REFERAT de verificare/ RAPORT de expertiza tehnica titlu/nr./data
<b>PROIECTANT DE SPECIALITATE</b> S.C. EURODRAFT PROJECT DESIGN S.R.L. Sanandrei, str. Magroiei, nr.14, Jud. Timis CUI: RO32707205; ORC: J35/157/2014 Tel: 0720 315 097; Fax: 0356 467 757 E-mail: office@eurodraftprojectdesign.ro				Titular: <b>Mun. Timisoara</b> Beneficiar: Asociatia de proprietari, str. Hamciei, nr.3, sc.A+B+C Amplasament: jud. Timis, mun. Timisoara, str. Hamciei, nr.3, sc.A+B+C, C.F. nr. 406418-C1, nr. topo. 26354 Denumire proiect: Reabilitare termica imobil - str. Hamciei, nr.3, sc.A+B+C Titlu plansa: <b>TABLOU DE TAMPLARIE          FERESTRE EXISTENTE PROPUSE SPRE          SCHIMBARE</b>
SPECIFICATIE	NUME	SEMNTATURA	Scara	Proiect nr. 132/4/2017
Sef proiect	arh. Trinca Cristian		1:50	Faza D.T.P.Th.+ C.S.+D.E.
Proiectat	arh. Trinca Cristian			Plansa nr. A.14-REV1
Desenat	arh. Trinca Cristian			
Verificat	ing. Gavrilscu Rodica		Data SEPT 2018	

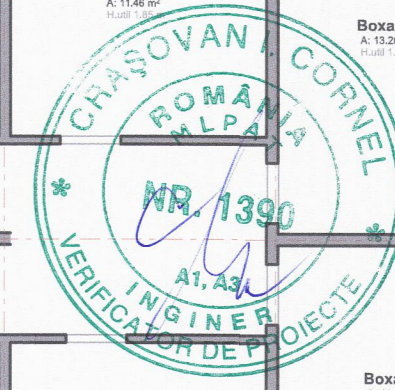
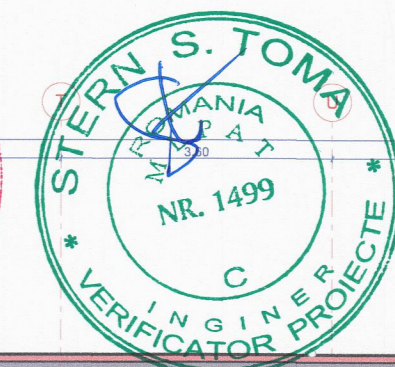
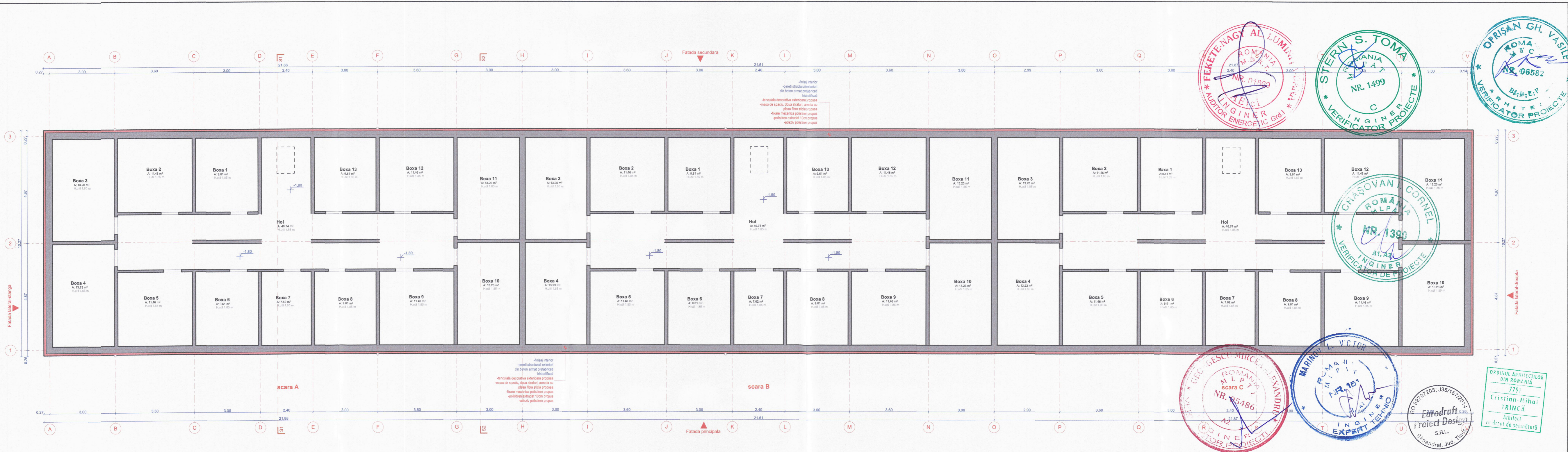

VERIFICATOR/ EXPERT	NUME	SEMNATURA	CERINTA	REFERAT de verificare/ RAPORT de expertiza tehnica titlu/nr./data	Proiect nr.
<b>PROIECTANT DE SPECIALITATE</b> S.C. EURODRAFT PROIECT DESIGN S.R.L. Sanandrei, str. Magnoliei, nr.14, jud.Timis CUI: RO32707205, ORC: J35/1572014; Tel: 0720 315 097; Fax: 0356 467 757 ISOROMCERT.ro E-mail: office@eurodraftproiectdesign.ro				Titular: Mun. Timisoara Beneficiar: Asociatia de proprietari, str. Harniciei, nr.3, sc.A+B+C Amplasament: jud. Timis, mun. Timisoara, str. Harniciei, nr.3, sc.A+B+C, C.F. nr. 406418-C1, nr. topo. 26354	1324/2017
SPECIFICATIE	NUME	SEMNATURA	Scara		
Sef proiect	arh. Trinca Cristian		1:100	Denumire proiect: Reabilitare termica imobil - str. str. Harniciei, nr.3, sc.A+B+C	Faza D.T.P.Th.+ C.S.+D.E.
Proiectat	arh. Trinca Cristian			Titlu plansa:	Plansa nr.
Desenat	arh. Trinca Cristian		Data SEPT 2018	<b>PLAN SUBSOL PROPOS</b>	A.15-REV1
Verificat	ing. Gavrilescu Rodica				

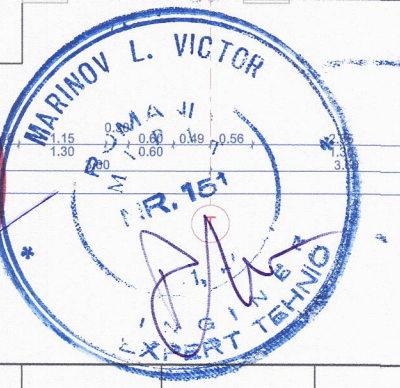
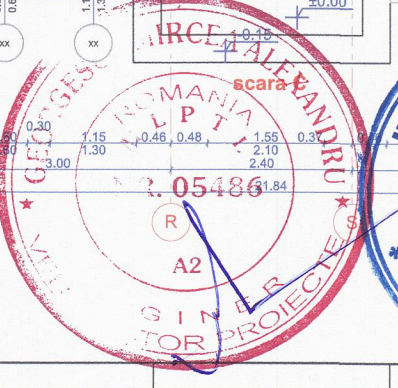
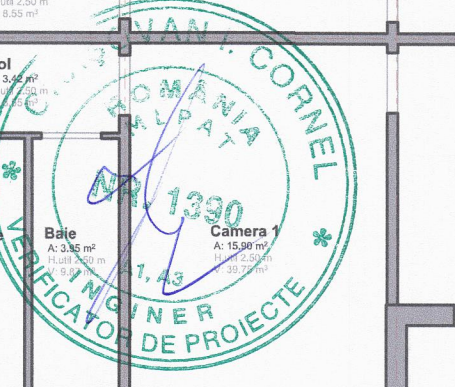
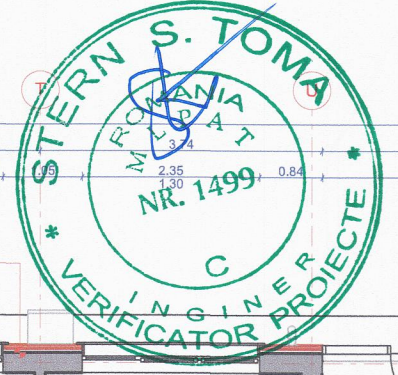
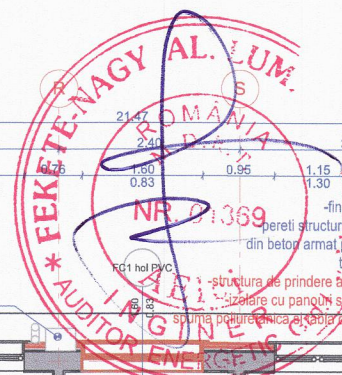
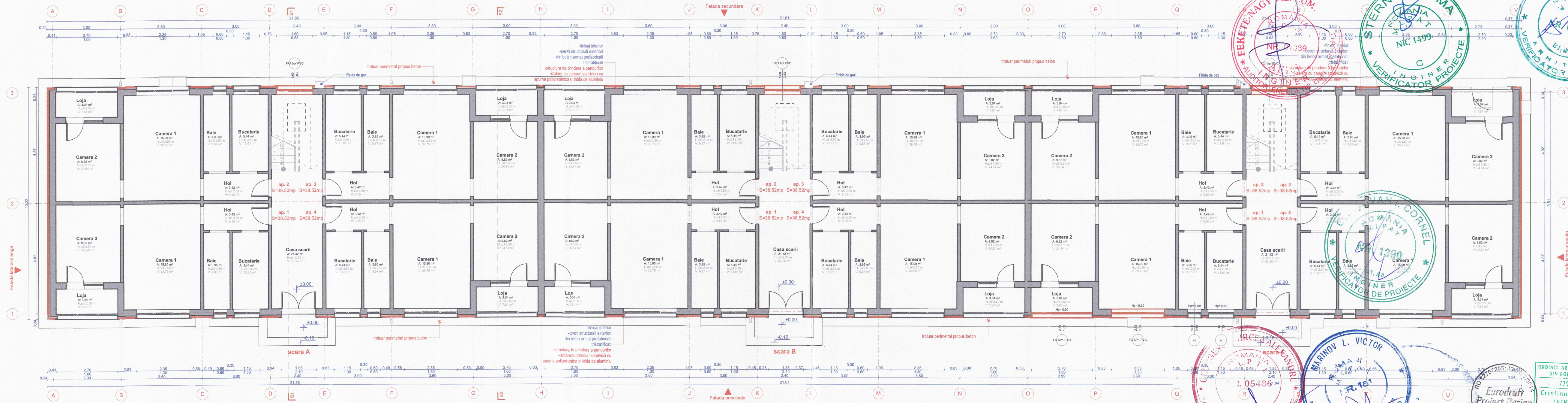

VERIFICATOR/ EXPERT	NUME	SEMNTATURA	CERINTA	REFERAT de verificare/ RAPORT de expertiza tehnica titlu/nr./data
<b>PROIECTANT DE SPECIALITATE</b> S.C. EURODRAFT PROJECT DESIGN S.R.L. Sanandrei, str. Magnoliei, nr.14, jud. Timis CUI: RO3270205, ORC: 035/157/2014 Tel: 0720 315 097; Fax: 0356 467 757 E-mail: office@eurodraftprojectdesign.ro				Titular: Mun. Timisoara Beneficiar: Asociatia de proprietari, str. Harniciei, nr.3, sc.A+B+C Amplasament: jud. Timis, mun. Timisoara, str. Harniciei, nr.3, sc.A+B+C, C.F. nr. 406418-C1, nr. topo. 26354
SPECIFICATIE Sef proiect Proiectat Desenat Verificat	NUME arh. Trinca Cristian arh. Trinca Cristian arh. Trinca Cristian ing. Gavrilcscu Rodica	SEMNTATURA    	Scara 1:100 Data SEPT 2018	Proiect nr. 132/4/2017 Faza D.T.P.Th.+ C.S.+D.E. Plansa nr. PLAN PARTER PROPUS A.16-REV1

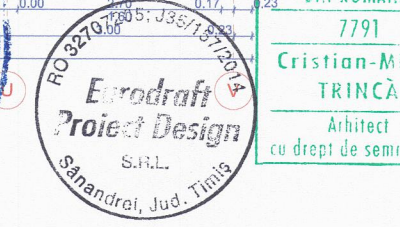
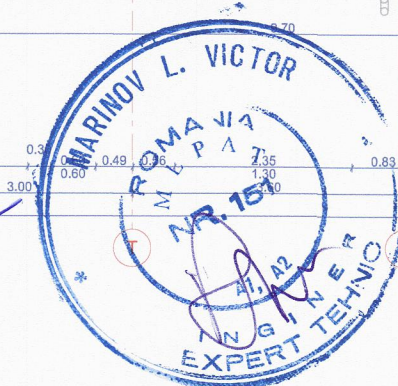
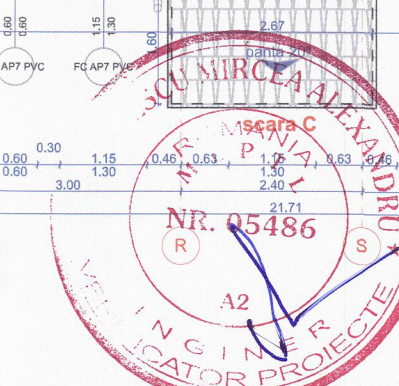
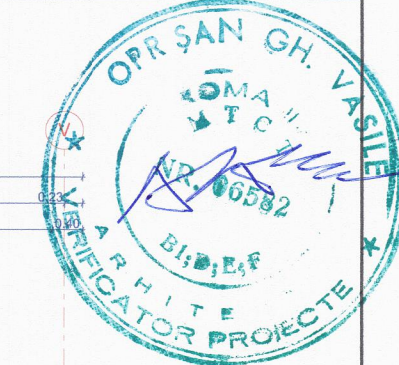
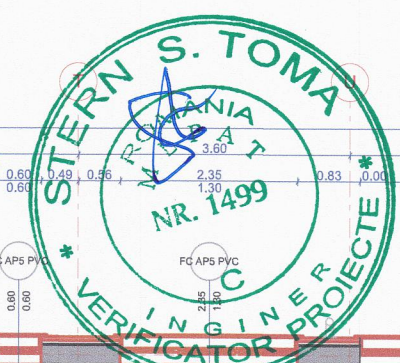
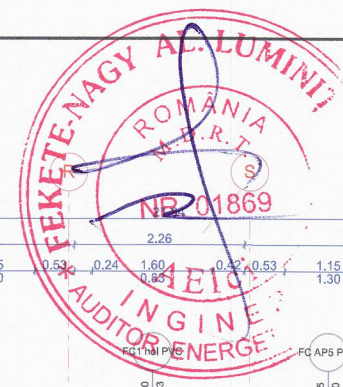
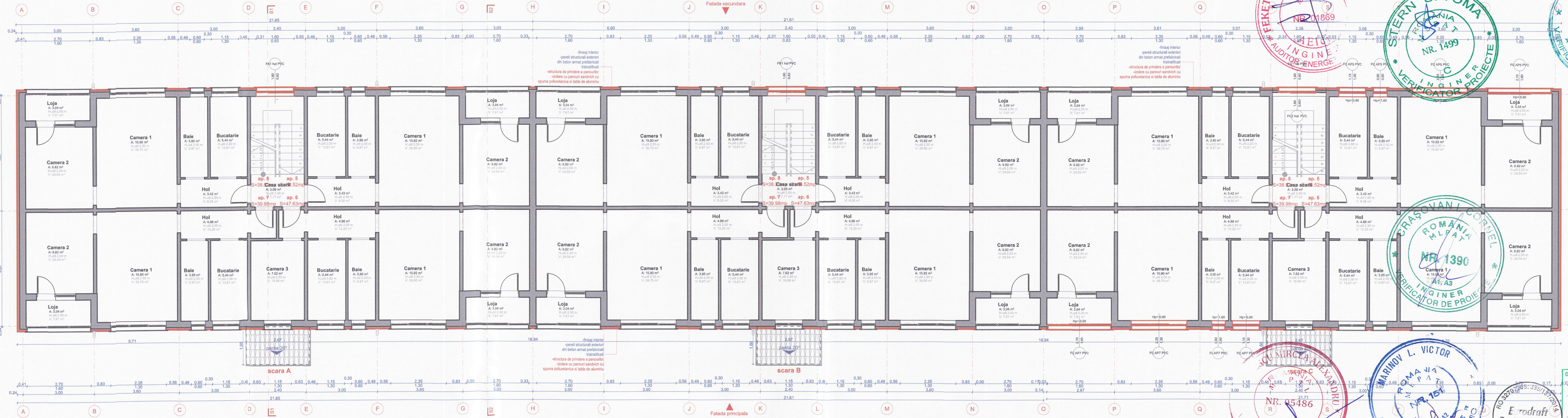

ORDINUL ARHITECTILOR  
DIN ROMANIA  
7791  
Cristian-Mihai  
TRINCA  
Arhitect  
cu drept de semnatura

VERIFICATOR/ EXPERT	NUME	SEMNTATURA	CERINTA	REFERAT de verificare/ RAPORT de expertiza tehnica titlu/nr./data	Proiect nr.
					132/4/2017
PROIECTANT DE SPECIALITATE				Titular:	
S.C. EURODRAFT PROIECT DESIGN S.R.L. Sanandrei, str. Magnoliei, nr.14, jud.Timis CUI: RO3270205; ORC: J35157/2014; Tel: 0720 315 097; Fax: 0356 467 757 E-mail: office@eurodraftproiectdesign.ro				Mun. Timisoara	
				Beneficiar:	
				Asociația de proprietari, str. Harniciei, nr.3, sc.A+B+C	
SPECIFICATIE				Amplasament:	
Sef proiect				jud. Timis, mun. Timisoara, str. Harniciei, nr.3, sc.A+B+C, C.F. nr. 406418-C1, nr. topo. 26354	
Proiectat				Denumire proiect:	
Desenat				Reabilitare termica imobil - str. Harniciei, nr.3, sc.A+B+C	Faza D.T.P.Th.+ C.S.+D.E.
Verificat				Titlu plansa:	
ing. Gavrilescu Rodica				PLAN ETAJ I PROPUS	Plansa nr. A.17-REV1

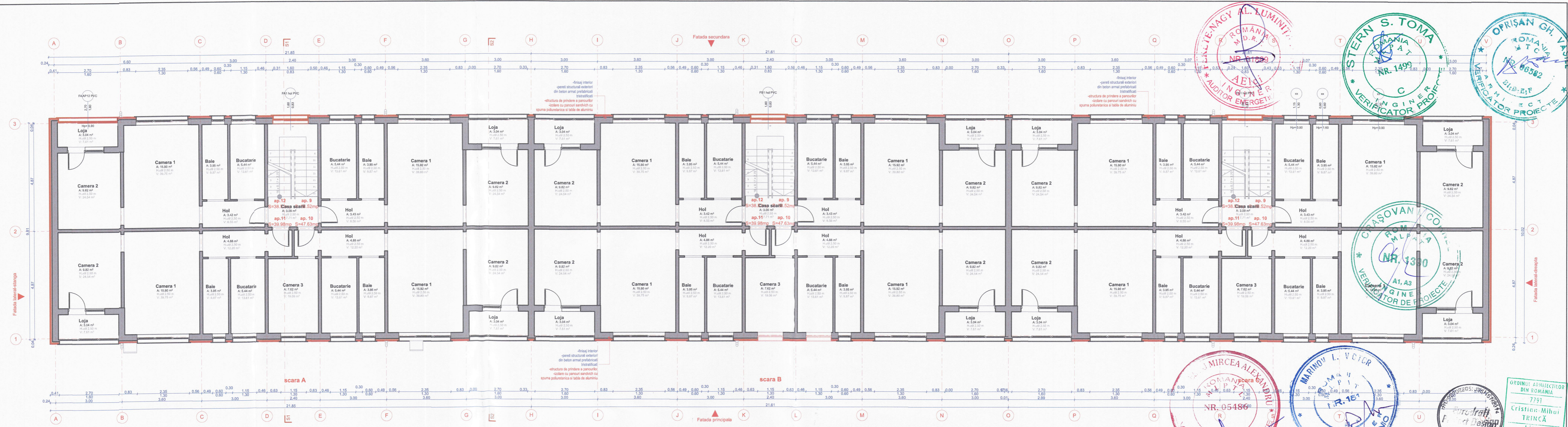

VERIFICATOR/ EXPERT	NUME	SEMNTATURA	CERINTA	REFERAT de verificare/ RAPORT de expertiza tehnica titlu/nr./data	
PROIECTANT DE SPECIALITATE				Titlu:	
S.C. EURODRAFT PROJECT DESIGN S.R.L. Sanandrei, str. Magyolei, nr.14, jud. Timis CUI: RO32707205, ORC: 335/157/2014; Tel: 0720 315 097; Fax: 0356 467 757 E-mail: office@eurodraftprojectdesign.ro				Mun. Timisoara	
 				Beneficiar:	
				Asociatia de proprietari, str. Harniciei, nr.3, sc.A+B+C	
				Amplasament:	
				jud. Timis, mun. Timisoara, str. Harniciei, nr.3, sc.A+B+C, C.F. nr. 406418-C1, nr. topo. 26354	
				Denumire proiect:	
				Reabilitare termica imobil - str. str. Harniciei, nr.3, sc.A+B+C	
				Faza	
				D.T.P.Th.+ C.S.+D.E.	
				Plansa nr.	
				A.18-REV1	
				Titlu plansa:	
				PLAN ETAJ II PROPUȘ	
				Data	
				SEPT 2018	
				Scara	
				1:100	
				Data	
				SEPT 2018	
				Titlu plansa:	
				PLAN ETAJ II PROPUȘ	
				Titlu plansa:	
				A.18-REV1	